

# COMPONENTI KIT DI MONTAGGIO MOUNTING KIT PARTS

**154-003-03133**

501-018-00105

Rosetta elastica / Washer



505-004-00014  
M10 CH14 H10  
Dado zincato  
Nut zinc plated

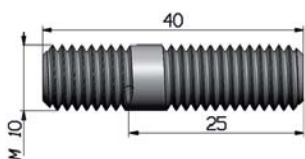

503-004-00027  
Prigionieri M10x25  
(trattamento Geomet)  
Stud M10x25  
(Geomet treated)

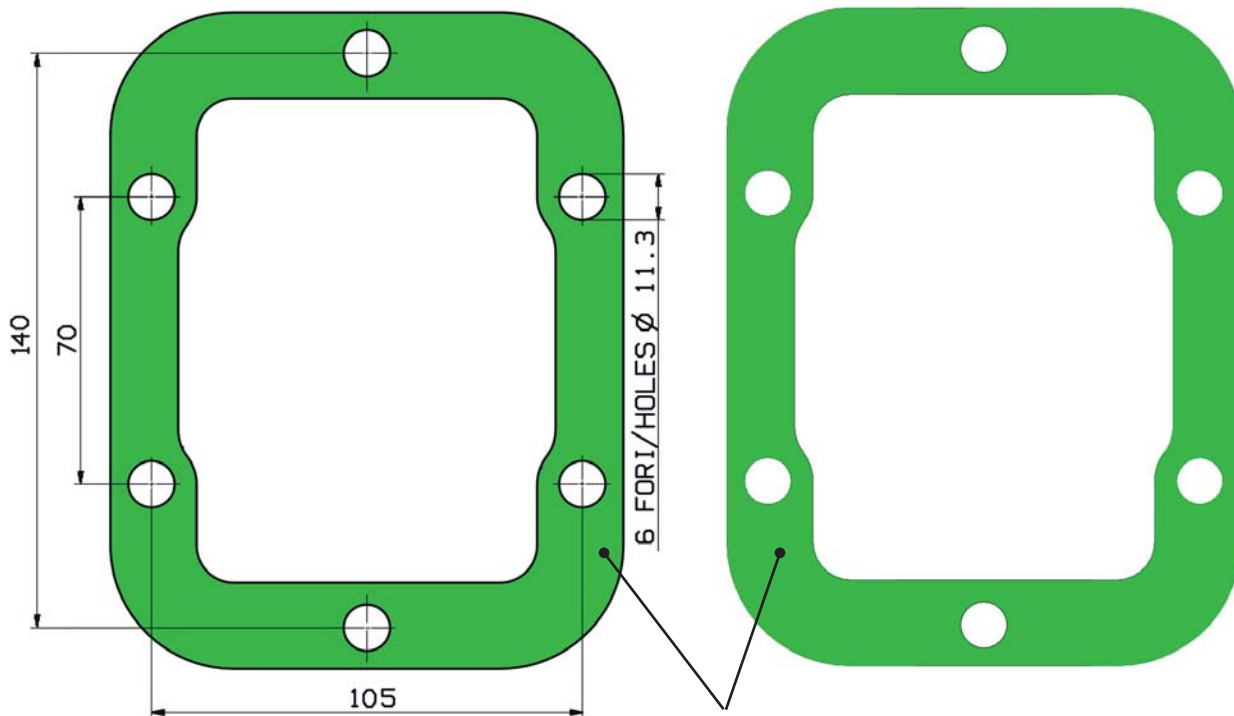

507-001-00068  
Guarnizione / Gasket  
(Material AFM 38 Thickness 0,5)

Data: Giovedì 17 maggio 2012

Codice foglio: 997-154-33133 Rev: AA